



MOUNTING INSTRUCTIONS

2321-0067 INDEPENDENT LOWERS FOR HONDA VTX 1300C

⚠ WARNING

Read and follow these instructions carefully. During installation, make certain that when turning the forks, there can be no interference with wiring or cables **AND**, that the Lowers/Hardware can not make contact with any part of the bike. Also make sure that the Lowers/Hardware do not interfere with the Shock travel, and that the Lowers/Hardware cannot contact the fender while braking.

The improper installation of this kit and related components could result in serious injury or death.

No additional tools required, that are not included in this kit:

1. Cover gas tank and front fender with towels to avoid damage during installation.
2. Attach the lowers plastic to the lowers mounting bracket using the pre-assembled bolts. The Santoprene grommets should be inserted through the holes in the lowers plastic so that the flat round part of the grommet lies flat on each side of the lowers plastic. (see Figure 1)
3. Loosely install the fork clamps on each fork. Remove the anchor bolt from each fork clamp and attach the brackets to the fork clamps. (see figure 2) The clamps should be positioned between the lower windshield fork clamp and the turn signal clamp, with the Dogleg pointing forward. (See figure 3)
4. Adjust height, angle and position, then remove the brackets and tighten the clamps on to forks. Reinstall brackets and tighten remaining bolts

NOTE: Improperly installed fork clamps will cause damage to your motorcycle. Before final installation make sure the Lowers and clamps will clear all fenders, radiators, oil coolers, turn signals and any other accessories when installed. Turn forks full left and right also apply front brake and rock the bike forward to check for proper clearance with no interference.

CAUTION

IMPORTANT CARE AND CLEANING INSTRUCTIONS

Memphis Shades Windshields and Lowers are made of Lucite® acrylic, and will last for years with proper care. Clean your windshield with plenty of soapy water — mild dishwashing liquid is best — and a soft cotton cloth. Use your bare hand to feel and dislodge bugs, or cover with a wet soapy towel and let it soak. Don't use paper towels and don't scrape with anything. Small scratches can be removed with NOVUS # 2.

NEVER use any glass cleaning products, petroleum based chemicals, or cleaning agents with ammonia, bleach or any other harsh chemicals. This includes (but not limited to) RainX, brake fluid, acetone, paint thinner, benzene and gasoline. "If it hurts your nose, it will hurt the plastic."

Glass cleansing agents will cause severe damage to your windshield, and will void your warranty.

NOTE: At certain times of the day the Sunlight can reflect off the curvature of a windshield and cause extreme heat build-up on motorcycle instruments and instrument panel. Take care when parking. Park facing the sun, place an opaque object over the instruments or position the bike to avoid reflections.

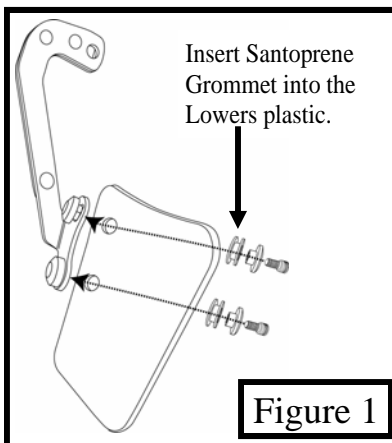
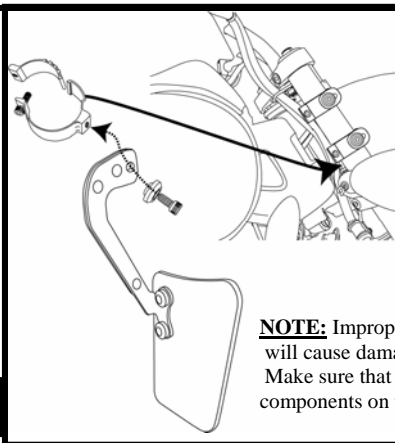

Figure 1



NOTE: Improperly installed fork clamps will cause damage to your motorcycle. Make sure that the fork clamps clear all components on the bike.

Figure 2

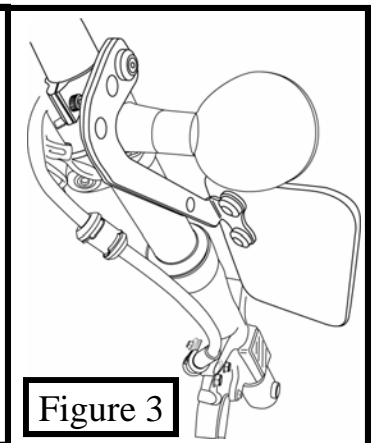

Figure 3



MOUNTING INSTRUCTIONS

2321-0067 INDEPENDENT LOWERS FOR HONDA VTX 1300C

| PART # | DESCRIPTION | QTY. |
|--------|---|------|
| M9860 | Mounting Instructions | 1 |
| S1165 | Lowrs Mounting Bracket Left Sub-Assembly | 1 |
| S1164 | Lowrs Mounting Bracket Right Sub-Assembly | 1 |
| S1074 | Small Adjustable Clamp Sub-Assembly | 2 |
| M314 | 3/16" T-Handle Allen Wrench | 1 |
| M337 | 3/16" T-Handle Allen Wrench Cover | 1 |

NOTE: Improperly installed fork clamps will cause damage to your motorcycle. Before final installation make sure the Lowrs and clamps will clear all fenders, radiators, oil coolers, turn signals and any other accessories when installed. Turn forks full left and right also apply front brake and rock the bike forward to check for proper clearance

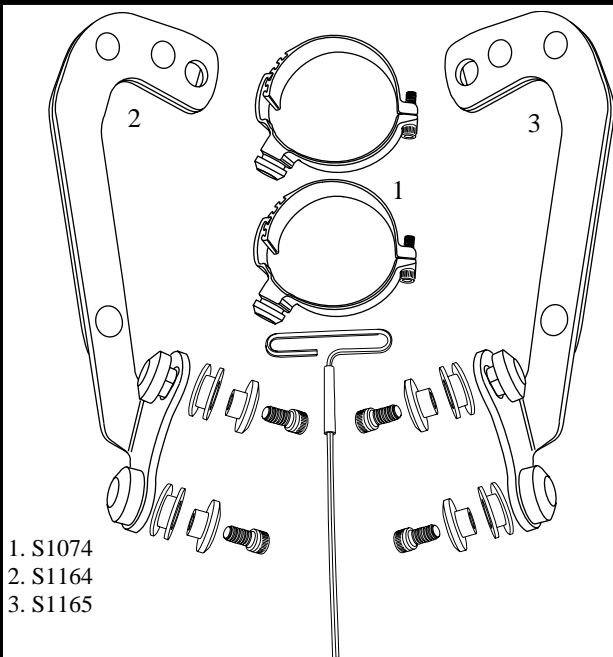
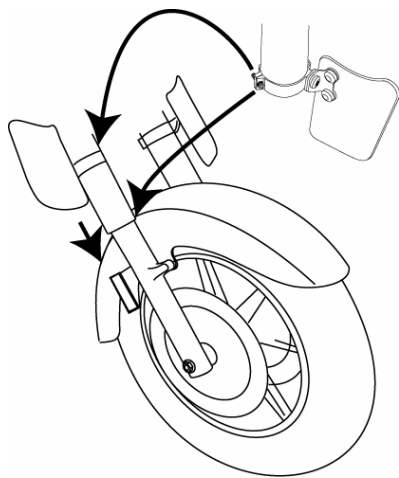

1. S1074
2. S1164
3. S1165

MEM9860 Mounting hardware kit

Memphis Shades warrants all product components, metal and plastic, against defects in materials and workmanship for 24 months.

FOR PARTS AND WARRANTY HELP, CONTACT:

MEMPHIS SHADES

P. O. Box 429

Rossville, TN 38066

(901) 853-0293

Visit us on the web at www.memphisshades.com or

you can also reach us at

customerservice@memphisshades.com