



Part No. 2320-0085

MEK1939

REVISION 1

HD Road King FLHR,FLHRI,FLHRCI,1994-2010
Bullet FX Fairing, HD Road King
Mounting kit

Detachable system allows easy removal.
Stylish and Functional.

Before assembly, read Warnings inside



WARNING

1. During installation, make sure that the fairing and hardware do not interfere with any cables or wiring when the forks are turned all the way in either direction. Also make sure , through the full range of adjustment, that the fairing and hardware do not hit the gas tank.
2. This is a detachable fairing, ALWAYS make sure the locking mechanism is fully engaged after installing the fairing.
3. The improper installation of this kit and related components could result in serious injury or death.



CAUTION

1. Memphis Shades fairings are made from Lucite® acrylic, and will last for years with proper care. Clean your fairing with plenty of soapy water (mild dishwashing liquid is best) and a soft cotton cloth. Use your bare hands to feel and dislodge bugs, or cover with a wet, soapy towel and let it soak. Don't use paper towels and scrape with anything. Small scratches can be removed with NOVUS #2.
2. Never use any glass cleaning products, petroleum based chemicals, or cleaning agents with ammonia, bleach or any other harsh chemicals. This includes (but not limited to) RainX, brake fluid, acetone, paint thinner, benzene and gasoline. "If it hurts your nose, it will hurt the plastic."
3. Glass cleansing agents will cause severe damage to your fairing, and will void your warranty.
4. At certain times of the day the Sunlight can reflect off the curvature of a fairing and cause extreme heat build-up on motorcycle instruments and instrument panel. Take care when parking. Park facing the sun, place an opaque object over the instruments or adjust the fairing to avoid reflections.

1. Kit Contents

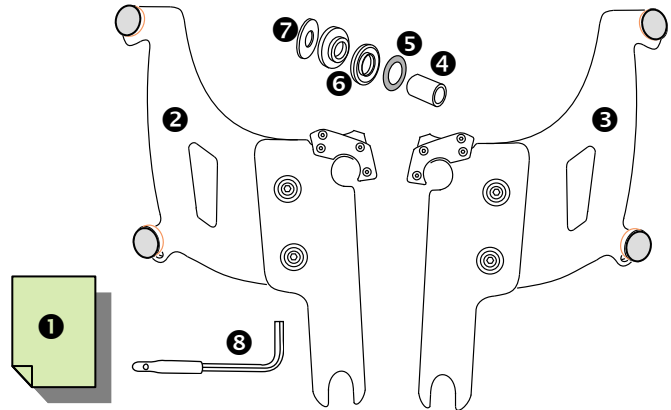

Ref	Code	Description	Qty
①	I1939	Mounting Instructions	1
②	M1468	Clutch side mounting plate	1
③	M1469	Throttle side mounting plate	1
④	M952	Roadking bushing insert	4
⑤	R324	#207 EPDM O Ring	4
⑥	R323	Bushing assembly (2 piece)	4
⑦	M321	Flat washer	4
⑧	M310	3/16" Short arm allen wrench	1

2. Mounting Instructions

1. Additional tools required, not included in this kit:
1/2" wrench or socket.
2. **Cover the gas tank and front fender with towels to avoid damage during installation.**
3. Install the two mounting plates onto the fairing, using the bolts which are pre-assembled to the mounting plates. The santoprene grommets should be inserted through the holes in the fairing so that the flat part of the grommet lies flat on each side of the plastic. The tabs point in towards the headlight when installed correctly. Fig 1
4. Remove the top and bottom acorn nut and washer on each side of the light bar. Fig 2

Memphis Shades warrants all product components, metal and plastic, against defects in materials and workmanship for 24 months.

For Parts and Warranty Help, Contact:

Memphis Shades, Inc.

P.O. Box 429

Rossville, TN 38066

(901) 853 0293

Visit us on the web at www.memphisshades.com or you can also reach us by email:

customerservice@memphisshades.com

HD Road King FLHR, FLHRI, FLHRCI, 1994-2010
 Bullet FX Fairing, HD Road King
 Mounting kit

2. Mounting Instructions, continued

5. Remove the light bar. Remove each rubber grommet and replace with new bushing assembly that includes aluminum bushing insert, plastic bushing with O Ring toward headlight and then stainless steel washer (Fig 3). Refit the light bar. Washer must be between light bar and bushing assembly. Loosely reinstall acorn nuts. Note: In some cases where the stud is too short to install the clutch cable guide it may be necessary to back out stud by tightening two 5/16" - 18 nuts together on stud and unscrew one or two turns.
6. Slip the fairing and the mounting plates onto the upper and lower bushings, and secure the left and right locking mechanism. (See Figs 4a and 4b). Tighten all four light bar acorn nuts.
7. This is a detachable fairing / windshield, ALWAYS make sure the Locking Mechanism is fully engaged after installation (See Fig 5)
8. Use the slotted holes in the plates to adjust the height and rake angle for the best fit.

Fig. 1

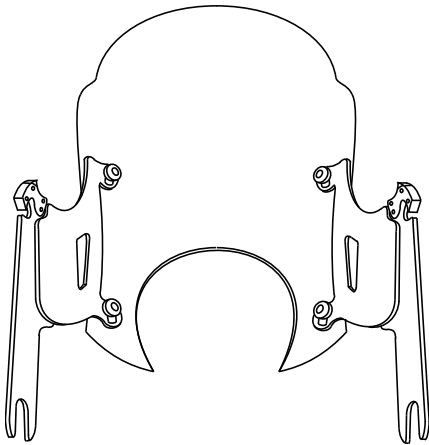

Fig. 2

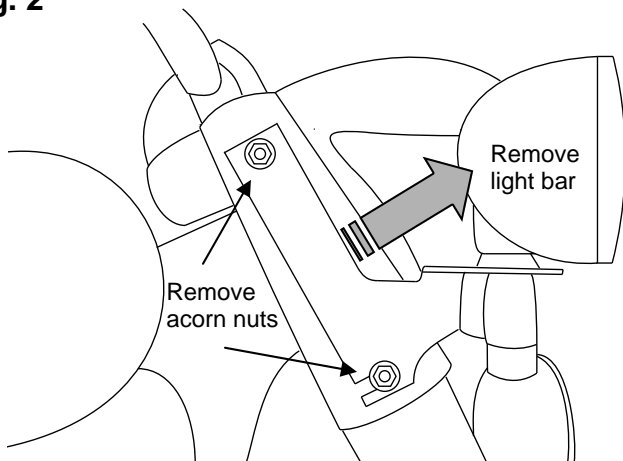

Fig. 3

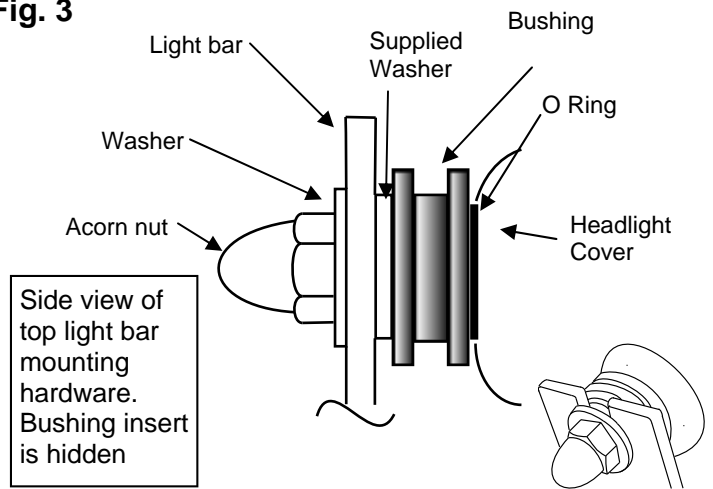

Fig. 4a

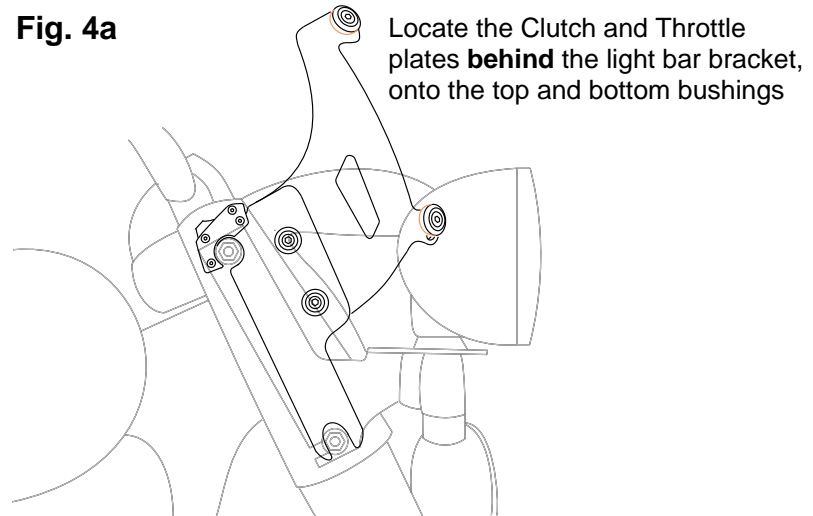
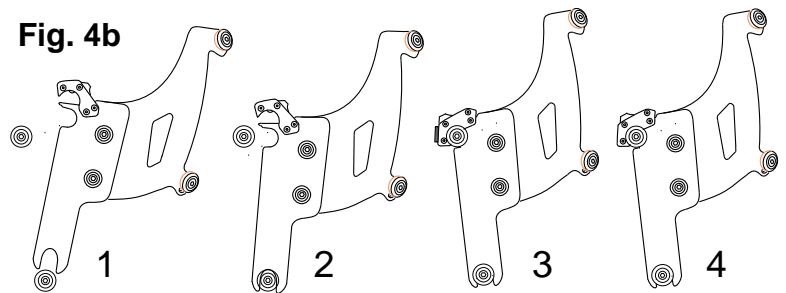

Fig. 4b



1. Place lower slot into lower bushing.
2. Rotate top slot into place.
3. Secure locking Mechanism.
4. Loosen Allen Bolt to adjust angle, then re-tighten Allen Bolt.

Fig. 5

